

Arizona Department of Transportation

I-10 Broadway Curve Improvement Project

UPDATE (JAN. 21, 2022): 48TH STREET CLOSURE

Utility relocation work in the 48th Street area between Elwood Street and Br San Fran Canal (also known as the Tempe Drain) is scheduled to continue through February 2022. This utility work requires closing 48th Street between Elwood Street and the Br San Fran Canal. This work will also limit business access at times to one driveway each, but will provide adequate access for first responders in case of an emergency. Crews will move the full closure work zone on 48th Street from Area 1 (shown below) to Area 2 beginning at 10 p.m. Saturday, Jan. 29, until 4 a.m. Sunday Jan. 30. Allow extra travel time as delays are possible. Please use caution around construction personnel and equipment. Thank you for your continued patience!

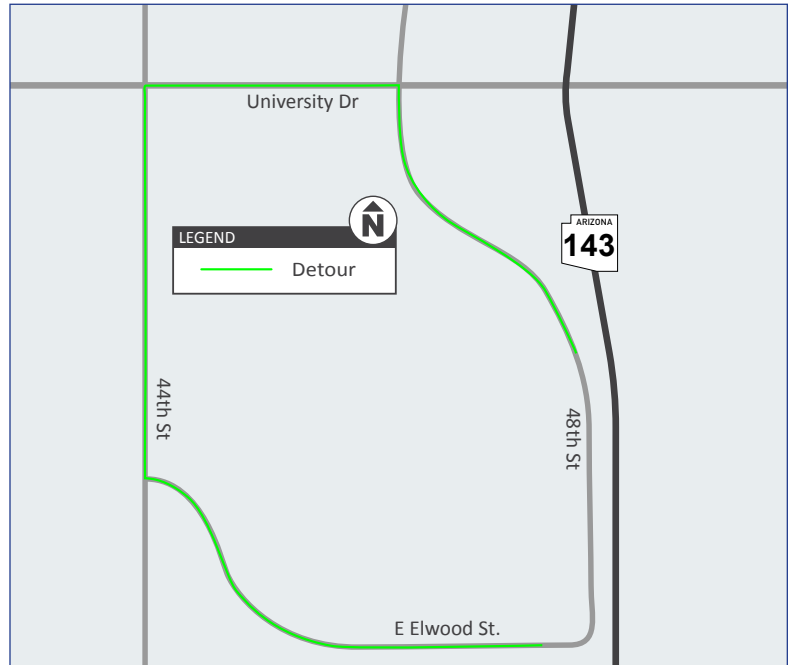
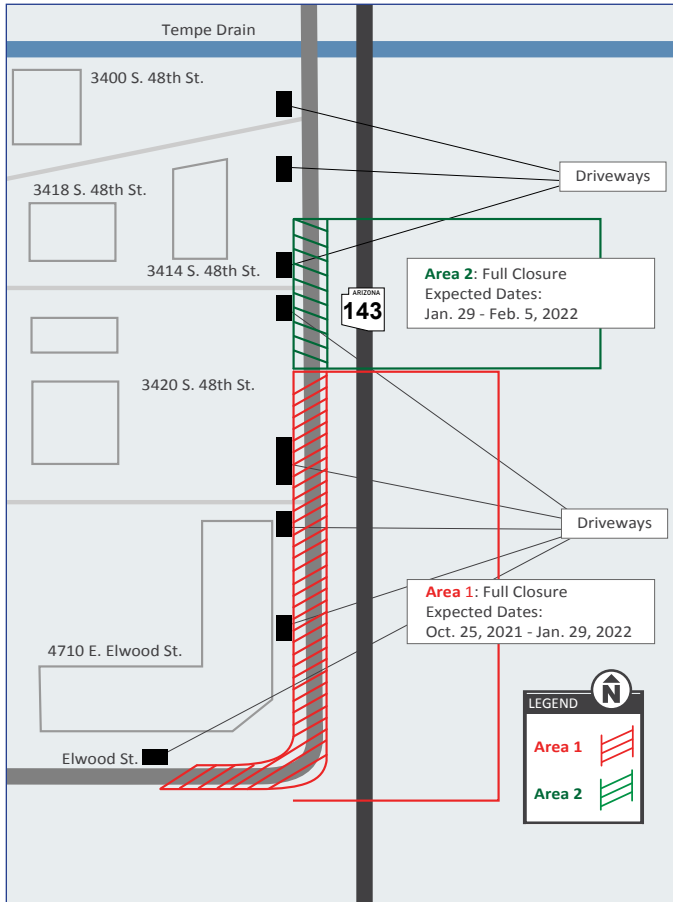

Northbound detour: Take Elwood Street to 44th Street. Take 44th Street north to University Drive. Turn right onto University Drive and turn right onto 48th Street.

Southbound detour: Take 48th Street north to University Drive. Turn left onto University Drive. Turn left onto 44th Street and turn left onto Elwood Street.

Sign up to receive traffic alerts and updates: i10BroadwayCurve.com



Stay #AheadOfTheCurve and download the free mobile app, The Curve!



For More Information:



Bilingual Project Information Line: 602.501.5505



Email: Info@i10BroadwayCurve.com



Online: i10BroadwayCurve.com



Arizona Department of Transportation

ADOT Project No. 010 MA 149 F007201C
Federal Aid No. 010-C(220)T