

Arizona Department of Transportation

I-10 Broadway Curve Improvement Project

UPDATE (NOV. 16): 48TH STREET CLOSURE

Utility relocation along 48th Street is scheduled to continue through February 2022. The work requires closing 48th Street between Elwood Street and the Br San Fran Canal (also known as the Tempe Drain). This work will also limit business access at times to one driveway each, but will provide adequate access for first responders in the case of an emergency. To guide drivers through a single travel lane, a flagging operation will be on-site from 8:30 a.m. to 4 p.m. through Wednesday, Nov. 24. Then, the flagging operation will switch to 8 p.m. to 4 a.m. beginning Monday, Nov. 29, continuing through Friday, Dec. 3. Allow extra travel time as delays are possible. Please use caution around construction personnel and equipment.

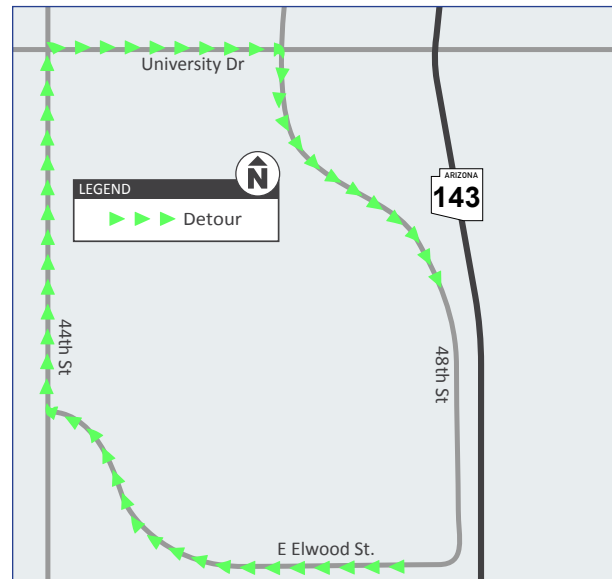
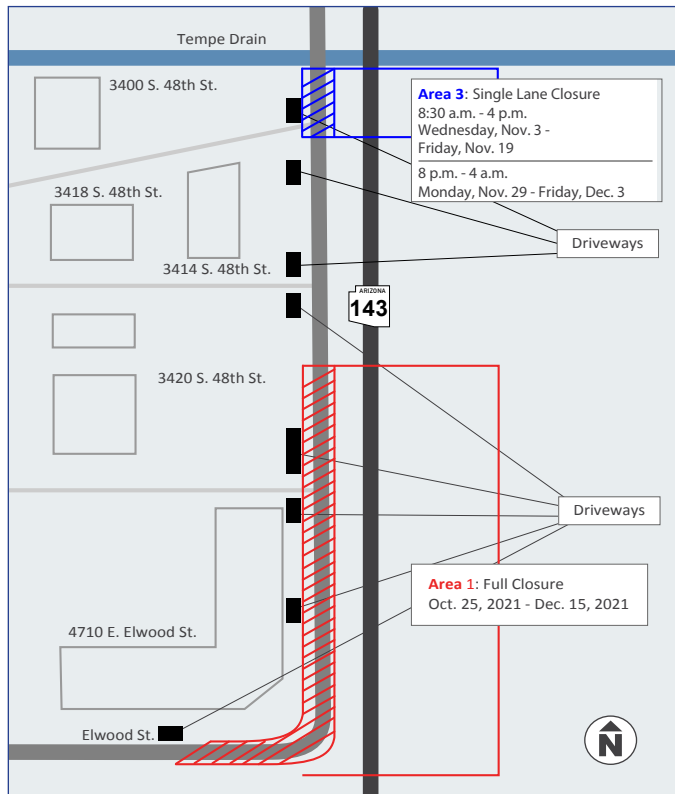

Northbound detour: Take Elwood Street to 44th Street. Take 44th Street north to University Drive. Take a right onto University Drive and another right onto 48th Street.

Southbound detour: Take 48th Street north to University Drive. Take a left onto University Drive. Take a left onto 44th Street and another left onto Elwood Street.

What to expect next: Construction will continue north in phases, with the next phase scheduled for December 2021 through January 2022. The final phase is scheduled for January and February 2022.

Stay #AheadOfTheCurve and download the free mobile app, The Curve!



Sign up to receive traffic alerts and updates: i10BroadwayCurve.com

For More Information:



Bilingual Project Information Line: 602.501.5505



Email: Info@i10BroadwayCurve.com



Online: i10BroadwayCurve.com



Arizona Department of Transportation

ADOT Project No. 010 MA 149 F007201C
Federal Aid No. 010-C(220)T